

PROPOSED KBL CENTURY PHASE -1

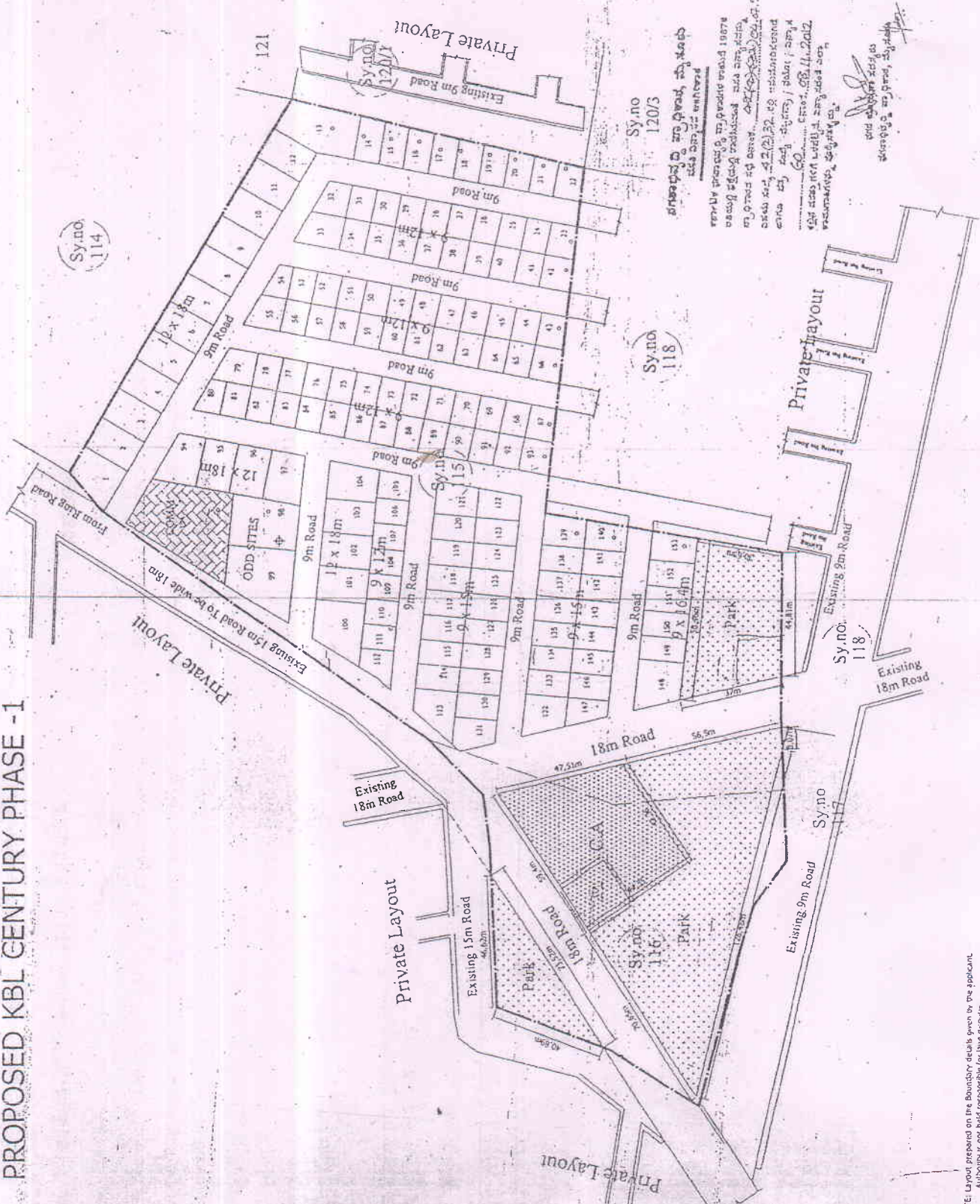
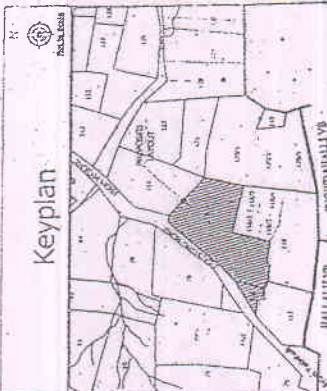

Site analysis:

SI no	Dimension in m	REGULAR	CORNER	ODD	TOTAL
1	12 x 18 m	16	05	01	22
2	9 x 12 m	65	00	15	80
3	9 x 18 m	27	06	02	35
4	9 x 18.4 m	01	01	01	03
5	ODD SITES	00	01	00	01
TOTAL		112	21	21	154

Landuse analysis:

SI NOS	LANDUSE	AREA in smt	% to Total
1	RESIDENTIAL	21934.00	48.60
2	COMMERCIAL	859.00	01.90
3	PARK	6768.50	15.00
4	C.A	2256.00	05.00
5	ROAD	13305.00	29.50
	TOTAL	45122.50	100.00

EXTENT = 11A - 06.05

MYSORE URBAN DEVELOPMENT AUTHORITY, MYSORE.
 115 & 116 of Lingabudhi village
 Kataka Hobli, Mysore Taluk.
 J/F of Owner: M/s KBL & Sons
 Represented by its Partner L. Ravu
 ADDRESS: TELUKOTE NO. - 1172331
 Date: 14.11.2012

DISTRICT BOARD MEMBER
 TOWN BOARD MEMBER
 COMMISSIONER

Sy.no 120/3
 Proposed by the owner, the roads to be provided are as follows:
 1. A 9m wide road to be provided along the boundary of the site.
 2. A 9m wide road to be provided along the boundary of the site.
 3. A 9m wide road to be provided along the boundary of the site.
 4. A 9m wide road to be provided along the boundary of the site.
 5. A 9m wide road to be provided along the boundary of the site.
 6. A 9m wide road to be provided along the boundary of the site.
 7. A 9m wide road to be provided along the boundary of the site.
 8. A 9m wide road to be provided along the boundary of the site.
 9. A 9m wide road to be provided along the boundary of the site.
 10. A 9m wide road to be provided along the boundary of the site.

NOTE: Layout prepared on the Boundary details given by the applicant. Authority is not held responsible for any disputes.